

- NOTES:
- 1) LOCATE DROP CURBS IN FIELD TO SUIT EXISTING DRIVEWAYS (MINIMUM 6m).
 - 2) NEW 400mmØ WATERMAIN TO BE LOCATED 2.5m EAST OF THE WESTERN LAKESHORE DRIVE EDGE OF PAVEMENT.
 - 3) WATER SUPPLY SHALL BE MAINTAINED TO ALL PROPERTIES THROUGHOUT THE PROJECT. ONLY EXCEPTION SHALL BE WHEN CONNECTION TO NEW WHICH SHALL BE LIMITED TO 4 HOURS AND SCHEDULED TO MINIMIZE INCONVENIENCE TO PROPERTIES. ALL INSTALLED WATERMAIN ENDS SHALL BE CAPPED TEMPORARILY UNTIL CONNECTIONS TO EXISTING ARE MADE.
 - 4)

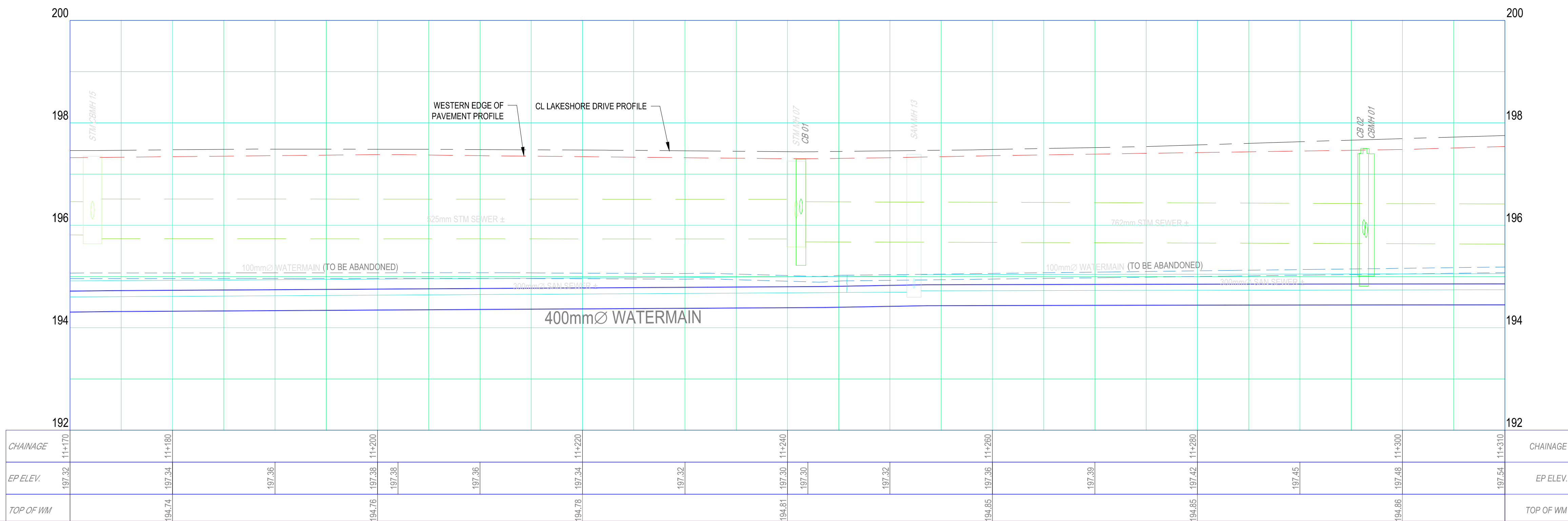
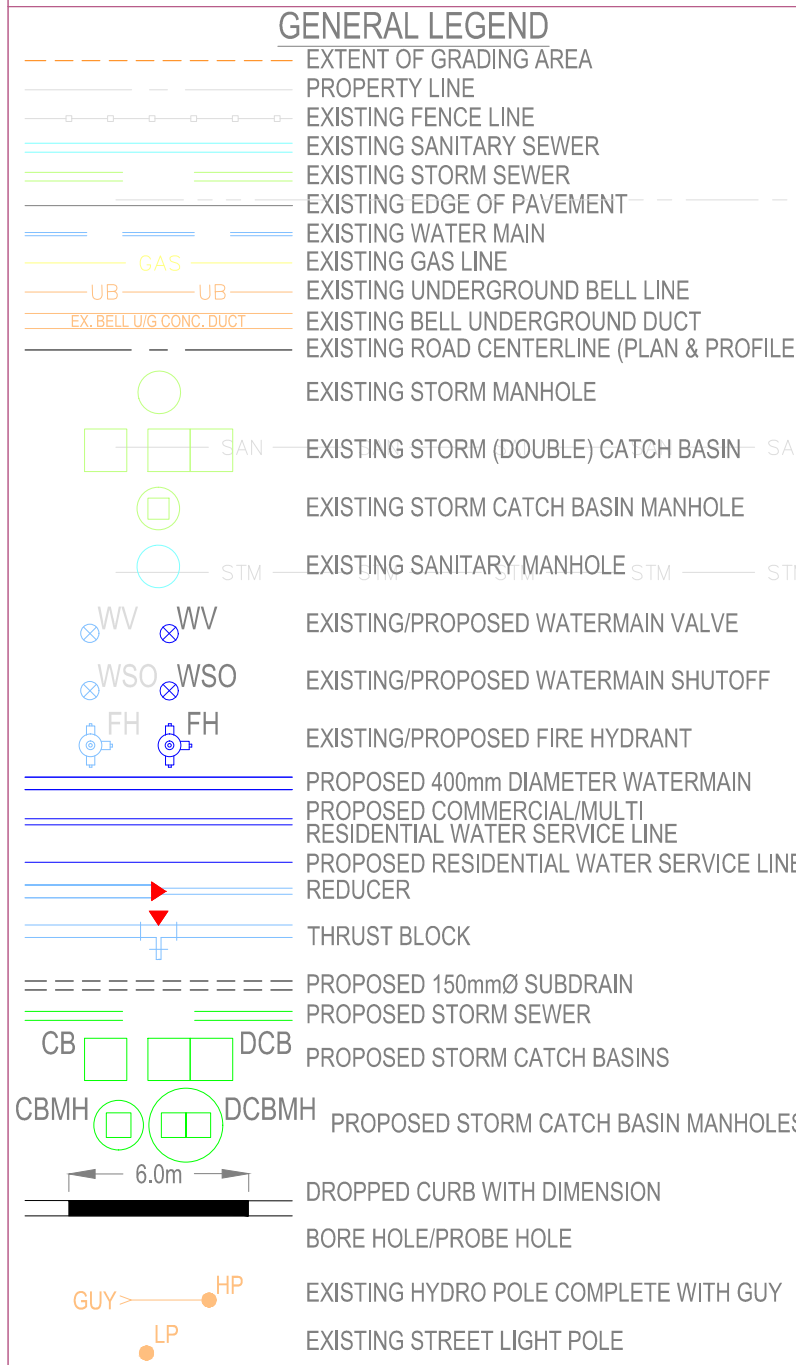

exp Services Inc.
Infrastructure Services - North Bay
8-1800 Bond Street
North Bay, Ontario, Canada
P1B 4V6
Ph: 705 474 2720
Fax: 705 474 8515

www.exp.com

• BUILDINGS • EARTH & ENVIRONMENT • ENERGY •
• INDUSTRIAL • INFRASTRUCTURE • SUSTAINABILITY •

ISSUED FOR CONSTRUCTION
CAUTION: DO NOT SCALE DRAWINGS.

THIS REPRODUCTION MAY BE AT A SIZE DIFFERENT THAN ORIGINALLY DRAWN. EXP ASSUMES NO RESPONSIBILITY FOR IMPROPER SCALING. UNAUTHORIZED REPRODUCTION OR REUSE IS STRICTLY PROHIBITED. NOT PUBLISHED - ALL RIGHTS RESERVED. EXP EXPRESSLY DISCLAIMS RESPONSIBILITY ARISING FROM UNAUTHORIZED USE OF THESE DRAWINGS AND NOTES. AUTHORIZATION MUST BE IN WRITING.

© exp, 2013

Corporation of the City of North Bay

Project Title
Upgrades to Lakeshore Drive Watermain PHASE 2
Marshall Park Drive to Sunset Boulevard

Dwg. Title
11+170 to Banner Avenue (11+251.6) to 11+310 New Construction Plan and Profile

Project No.
NB-09-5047

Dwg. No.
PH2-4

Rev. No.
L-43

\\CAD\ENGL\Lakeshore DW\Watermain upgrading Morgan to Mowat